

ASSEMBLY INSTRUCTION

SANTOS SECTIONAL

STEP 1:

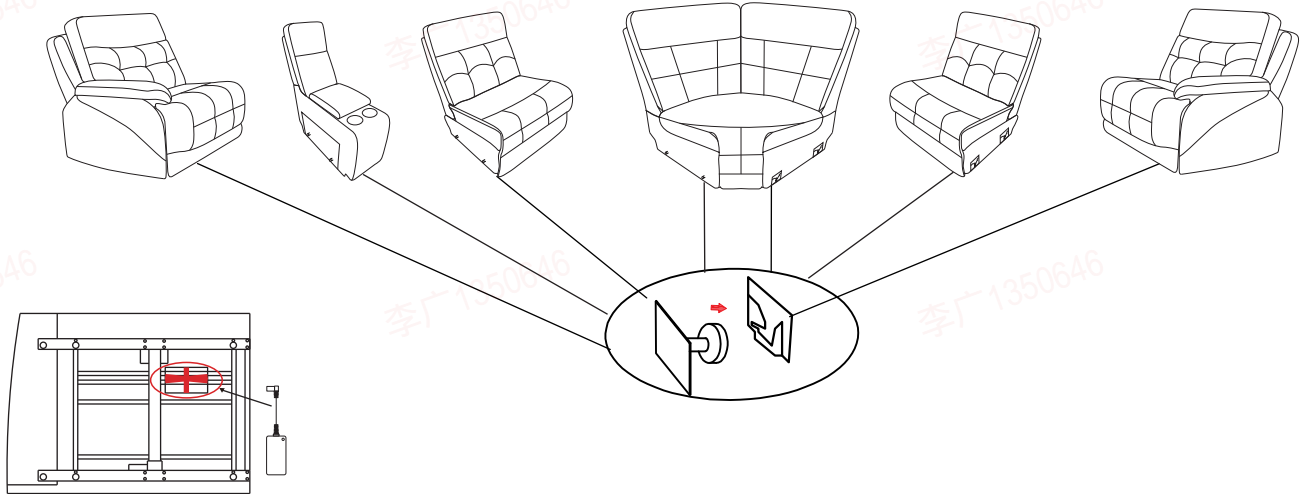

STEP 2:

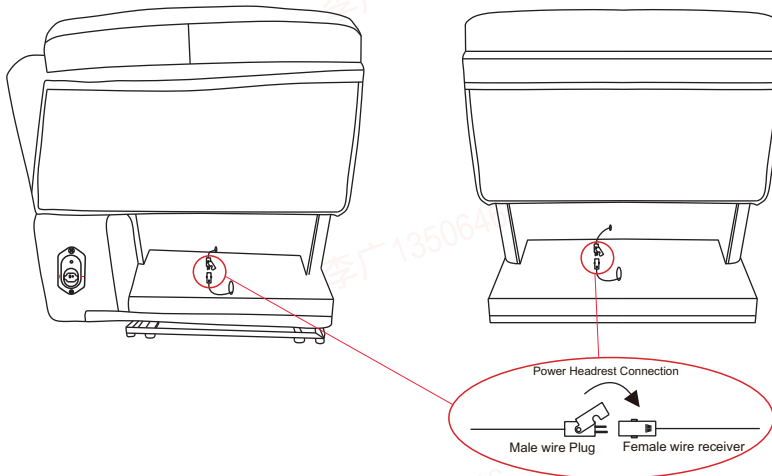

STEP 3:

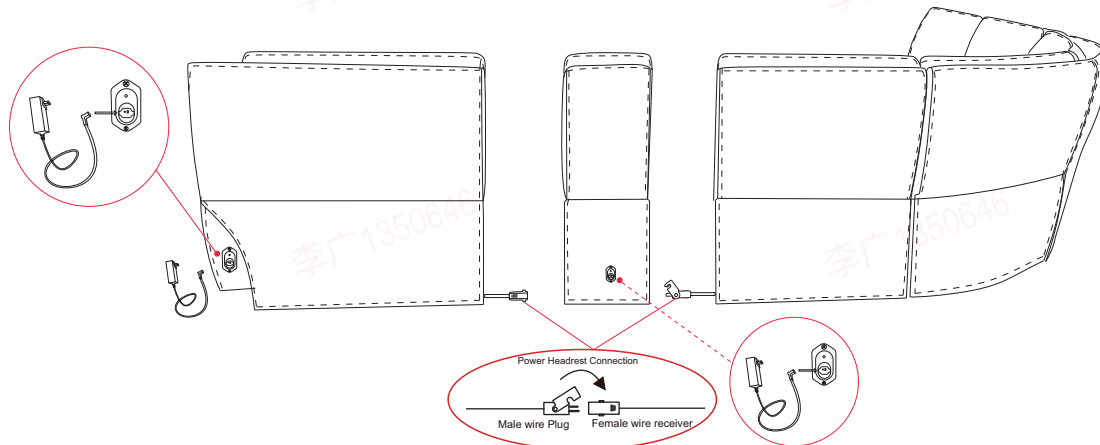

ASSEMBLY INSTRUCTION

SANTOS SECTIONAL

STEP 4: Connect wall plug transformer to transformer switch.

wall plug transformer to Transformer
Power Switch

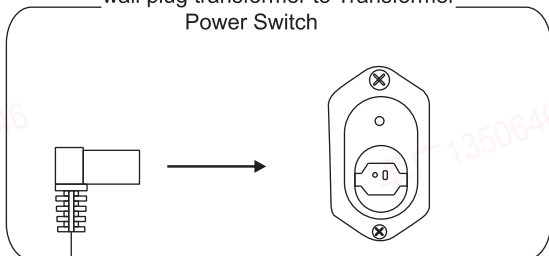

STEP 5: Connect wall plug transformer from Left Arm Seat to outlet.

wall plug transformer to Electrical Outlet

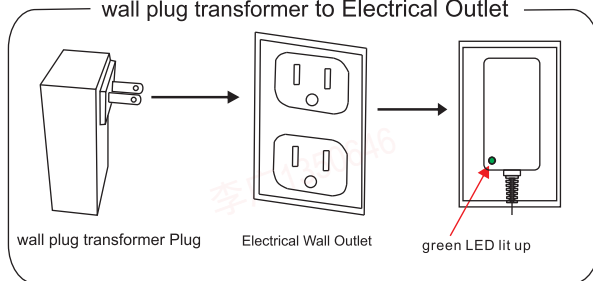

STEP 6: After all connections have been made, ensure that transformer power switch is switched to the "on" position.

Power Switch

Power switch

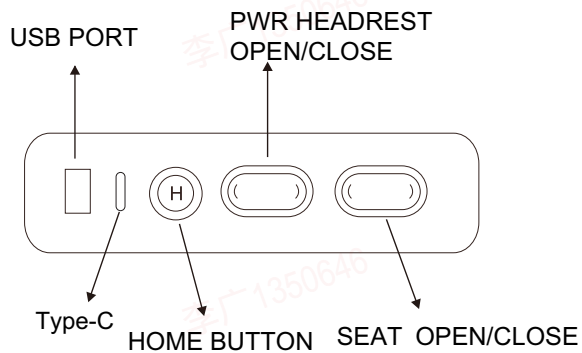
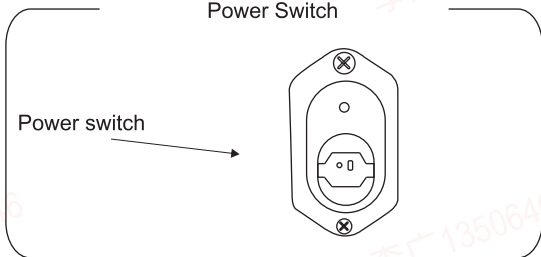

STEP 7:

